

NORTH CHRISTIAN CHURCH
Upper Level

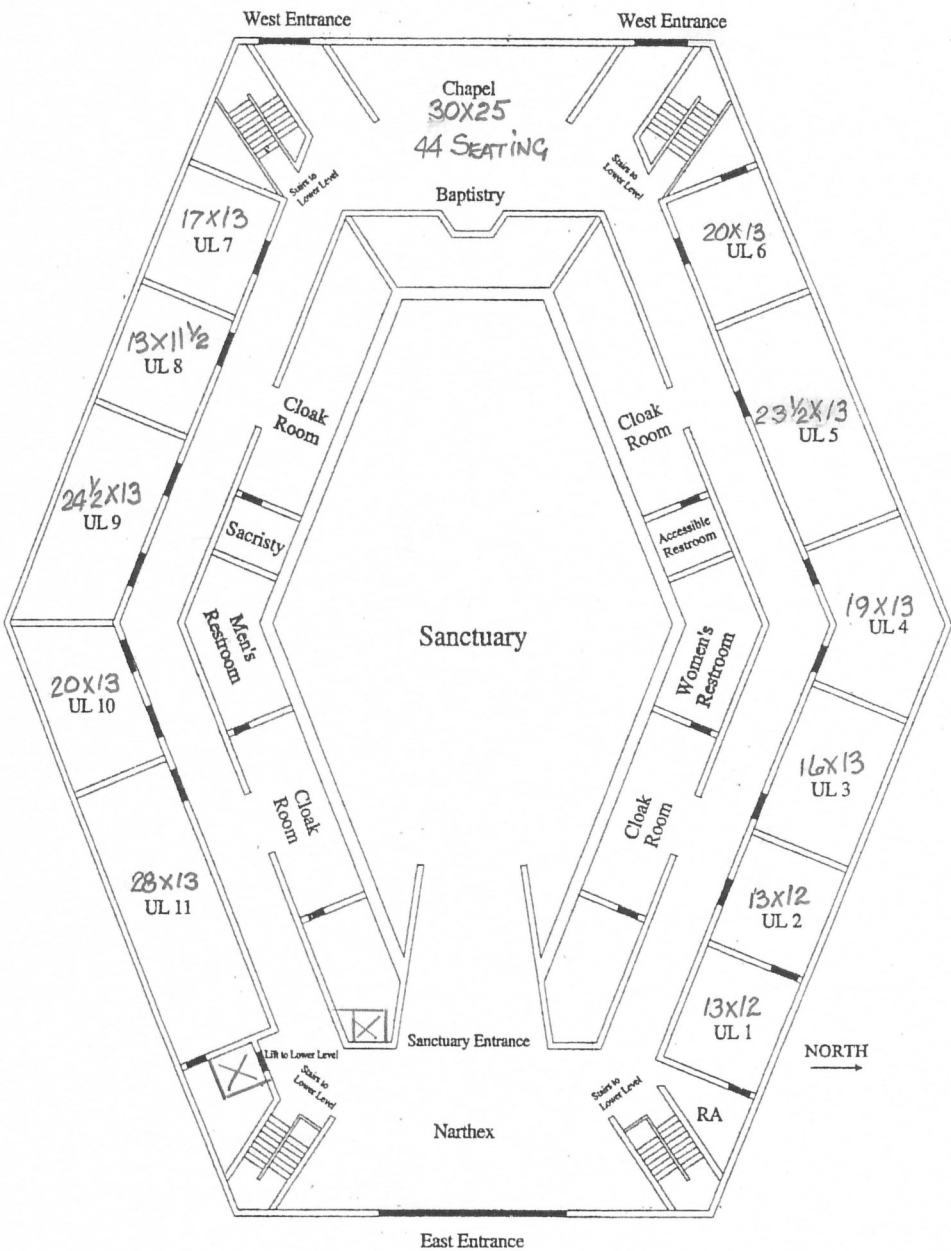

- | | | | |
|------|----------------------------|-------|--------------------------|
| UL 1 | Office | UL 7 | Cradle Roll |
| UL 2 | Work Room | UL 8 | Quiet Room |
| UL 3 | Minister of Children's Ed. | UL 9 | Childcare Suite |
| UL 4 | Director of Music | UL 10 | Preschool/Kindergarten |
| UL 5 | Senior Minister | UL 11 | Conference Room/ Library |
| UL 6 | Classroom | RA | Reception Area |

NORTH CHRISTIAN CHURCH
Lower Level

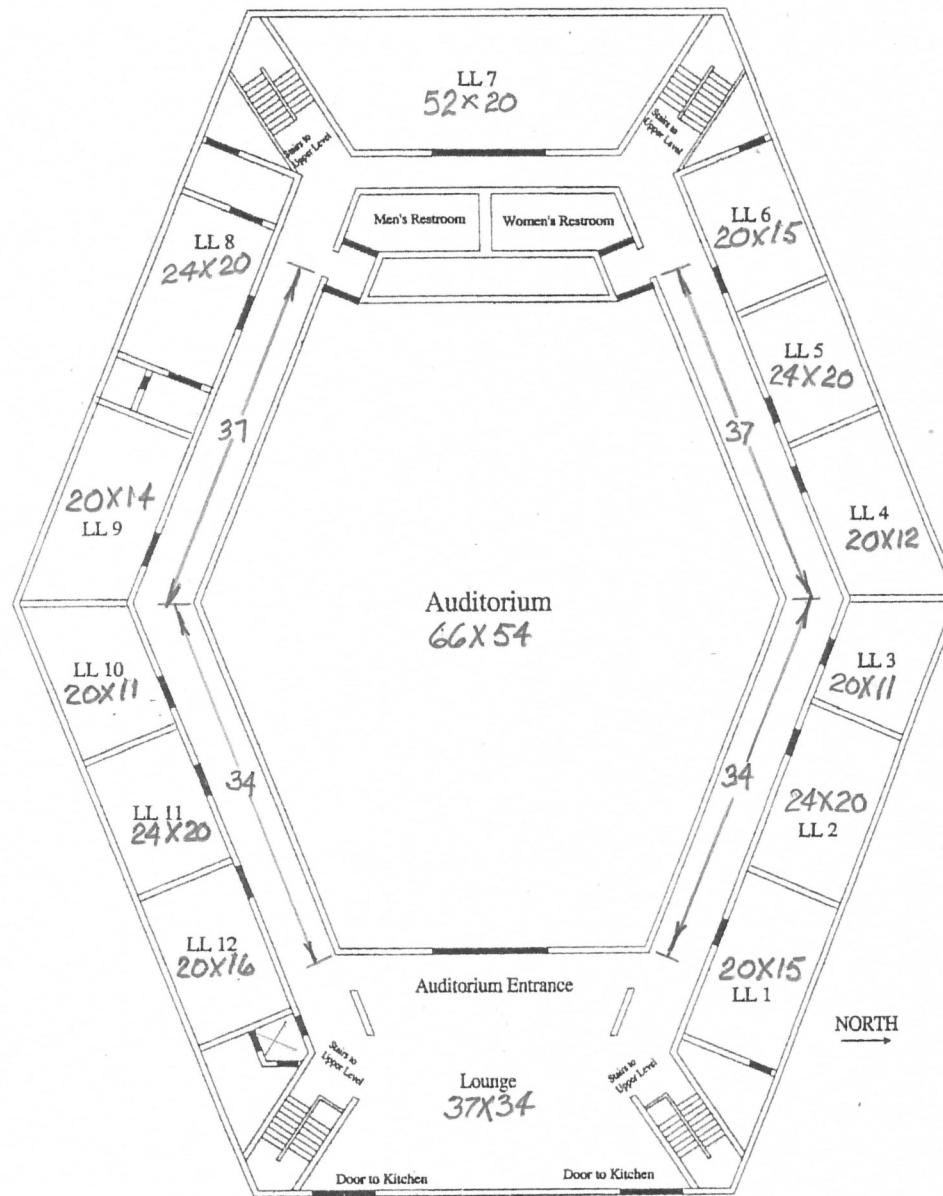

- | | | | |
|------|-----------------------------|-------|--------------------------------|
| LL 1 | Stone Pillar Room | LL 7 | Youth Room |
| LL 2 | Craft Room | LL 8 | Music Suite |
| LL 3 | Christian Learning Resource | LL 9 | Table / Chair / Banner Storage |
| LL 4 | Children's Library | LL 10 | Storage |
| LL 5 | Grades 1-6 | LL 11 | Children's Worship |
| LL 6 | Prayer Chapel | LL 12 | Bell Choir |